

R143C10B

printed on: 28-10-2024



TECHNICAL INFO

Media type	IMPREGNATED PAPER
Efficiency	10 $\mu\text{m}_{(c)}$ $\beta_x \geq 2$
Flow direction	OUT-IN
Collapse Δp	10 bar
Bypass setting	1.7 bar
Seals	NBR
Temperature range	-30°C +100°C

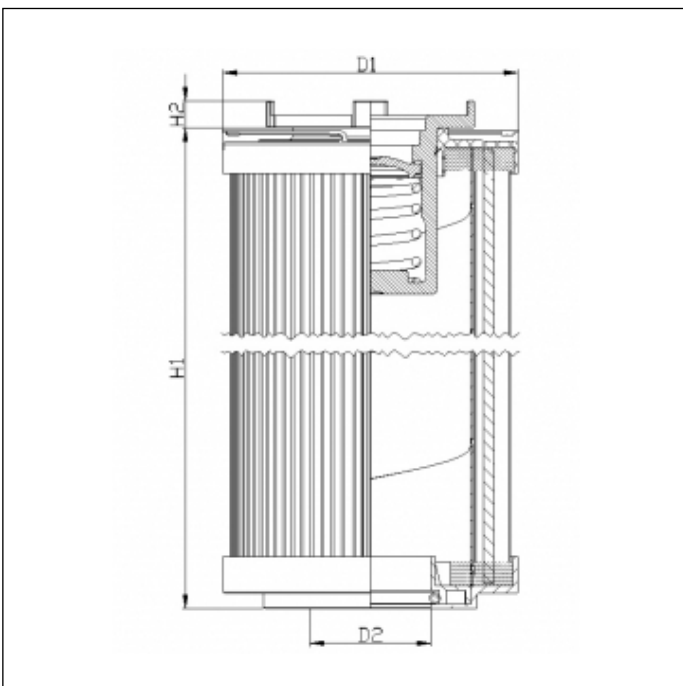

OVERALL DIMENSIONS

D1	99,0 mm
D2	40,5 mm
H1	256,0 mm
H2	9,0 mm

Technical information may change without notice. Image and drawing are representative only