

R160C25B

printed on: 11-05-2024



TECHNICAL INFO

| | |
|---------------------|---|
| Media type | IMPREGNATED PAPER |
| Efficiency | 25 $\mu\text{m}_{(c)}$ $\beta_x \geq 2$ |
| Flow direction | OUT-IN |
| Collapse Δp | 10 bar |
| Bypass setting | 1.7 bar |
| Seals | NBR |
| Temperature range | -30°C +100°C |

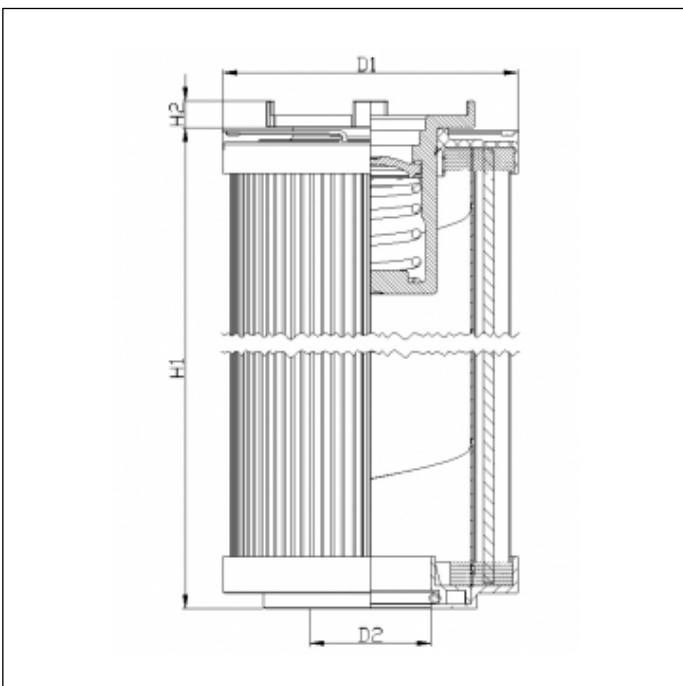

OVERALL DIMENSIONS

| | |
|----|----------|
| D1 | 130,0 mm |
| D2 | 64,5 mm |
| H1 | 200,0 mm |
| H2 | 9,0 mm |

Technical information may change without notice. Image and drawing are representative only